

20mA Split Core Current Transformer

Split core, 20mA output

Model: CTSA Series

Characteristics:

Technical Index:

Hanging installation,

Material of Core: silicon steel sheet

Work Voltage: $\leq 660\text{Vac}$

Operation Temperature: $-15^{\circ}\text{C}\sim+50^{\circ}\text{C}$

Work Frequency: 50HZ~1KHZ



Specification:

Rated Input (Effective Value)	30A	50A	100A	150A	200A	250A	300A	400A
Accuracy Class	0.5	0.5	0.5	0.5	0.5	0.5	0.5	0.5
Inner Diameter	16	10	16	24	24	35	35	35
Measurement Range	20~120%							
Rated Output	20mA							
Frequency	50~60Hz							
Weight	120g	110g	120g	350g	350g	410g	450g	500g

Outline Size(in:mm):

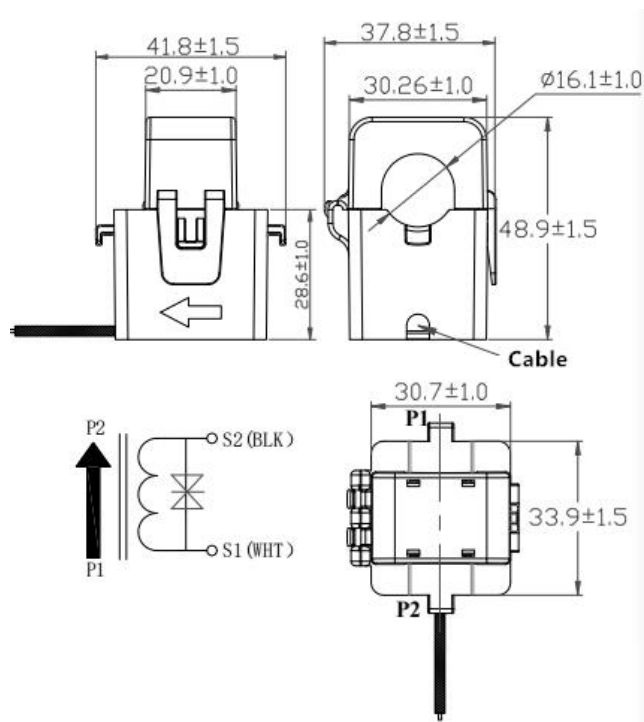

Inner Diameter 16mm

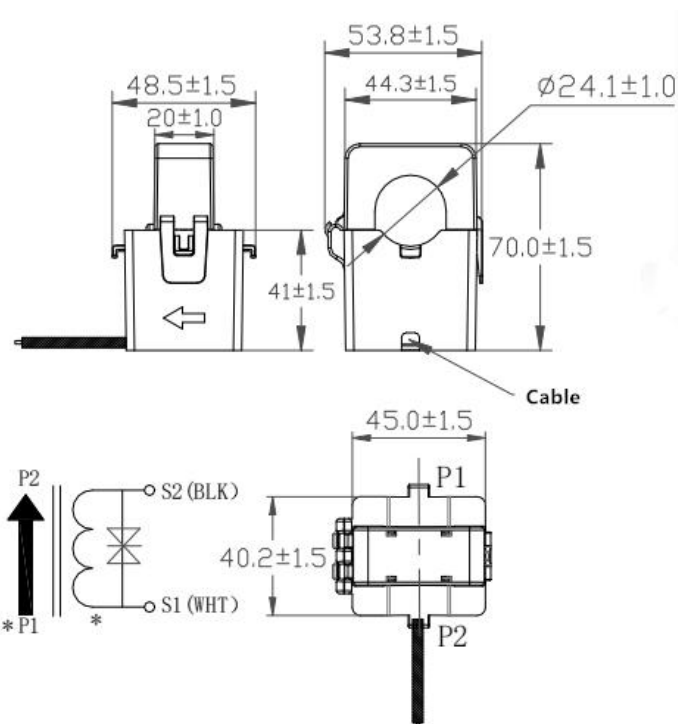

Inner Diameter 24mm

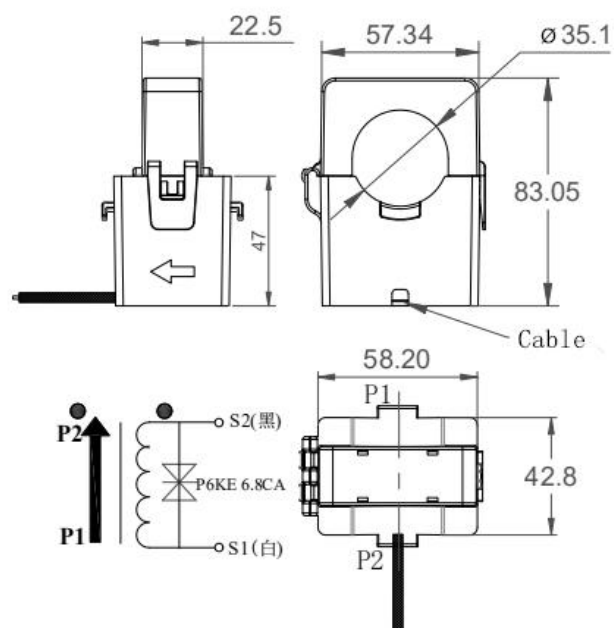

Inner Diameter 35mm

Installation Diagram

Primary coil through hole method

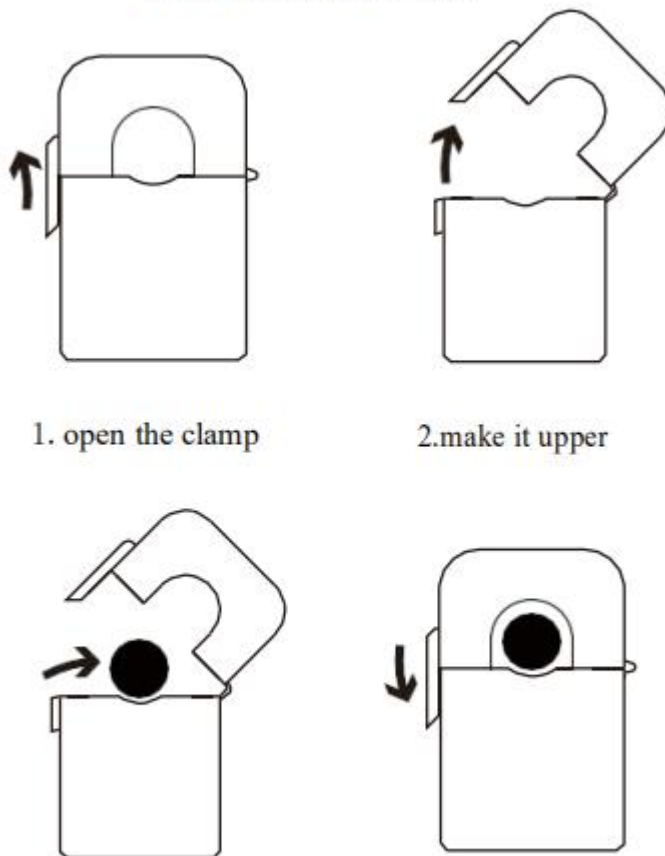

3.put the primary coil in the hole 4.close the clamp